

Eyebolt without pin DIN 582 in AISI-316 stainless steel

The following instructions must be taken into account for DIN 582 eyebolts, in addition to the load values in the table below.

The ring must be screwed completely to achieve perfect contact between the two paired faces.

Both threads must be the same length and the base and thread material must have the same strength.

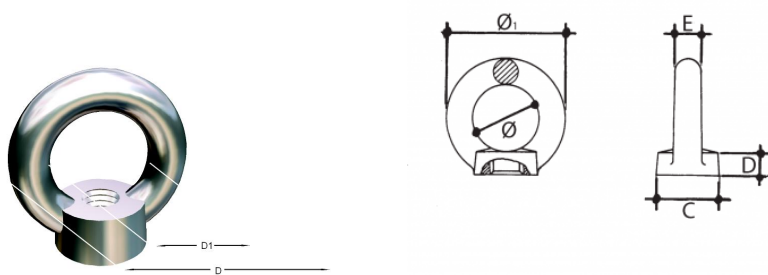

Technical information

Dimensiones							
Medida	Ø	Ø1	C	D	E	Carga Trabajo	Peso
M 8	20	36	20	8.5	8	300	0.05
M 10	25	45	25	10	10	500	0.09
M 12	30	54	30	11	12	800	0.145
M 14	30	54	30	11	12	1100	0.17
M 16	35	63	35	13	14	1500	0.22
M 20	40	72	40	16	16	2400	0.34
M 24	50	90	50	20	20	3600	0.72