

sim. DIN 316 AF

Tornillo de mariposa

Forma americana

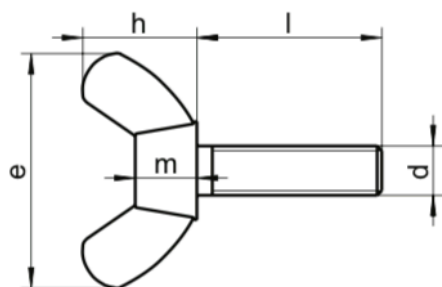

e	17,6	18,0	24,0	30,0	36,0	48,0	62,0
h	8,6	8,5	11,0	15,0	18,0	23,0	31,0
m	2,4	3,2	4,0	5,0	6,5	8,0	10,0
g	1,2	1,6	2,1	2,5	2,8	3,3	4,5
Long. / Ø	M3	M4	M5	M6	M8	M10	M12
10	▲●	▲●	▲●	▲●	▲●		
12	▲●	▲●	▲●	▲●	▲●		
16	▲●	▲●	▲●	▲●	▲●	▲●	
20	▲●	▲●	▲●	▲●	▲●	▲●	▲●
25	▲●	▲●	▲●	▲●	▲●	▲●	▲●
30	▲●	▲●	▲●	▲●	▲●	▲●	▲●
35		▲●	▲●	▲●	▲●	▲●	
40		▲●	▲●	▲●	▲●	▲●	
45			▲●	▲●	▲●	▲●	
50			▲●	▲●	▲●	▲●	
55					▲●	▲●	
60					▲●	▲●	
UV	100	100	50	50	50	25	25

■ A1 / ▲ A2 / ● A4 | UV: Unidad de venta | Todas las medidas en mm | Otras dimensiones bajo pedido
Ejemplo Art.-Nr.: 316-2-8X40 DIN 316 - A2 - M8 - l = 40mm - Tipo americano