

sim. DIN 9021

Arandela ancha

de poliamida natural

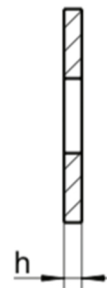
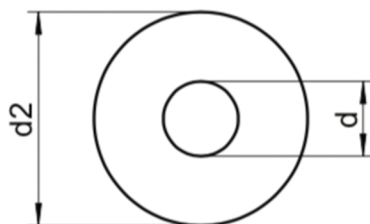

d	para Rosca	d2	h
3,2	M3	9	0,8
4,3	M4	12	1,0
5,3	M5	15	1,2
6,4	M6	18	1,6
8,4	M8	24	2,0
10,5	M10	30	2,5
13,0	M12	37	3,0
17,0	M16	50	3,0
20,0	M18	56	4,0
22,0	M20	60	4,0
26,0	M24	72	5,0
33,0	M30	92	6,0
39,0	M36	110	8,0

Grado	UV
Poliamida	1000
Poliamida	1000
Poliamida	1000
Poliamida	1000
Poliamida	1000
Poliamida	1000
Poliamida	500
Poliamida	200
Poliamida	100
Poliamida	100
Poliamida	50
Poliamida	50
Poliamida	25

■ A1 / ▲ A2 / ● A4 | UV: Unidad de venta | Todas las medidas en mm | Otras dimensiones bajo pedido
Ejemplo Art.-Nr.: 9510 8,4 WS 9510 - Ø 8,4mm