

sim. ISO 4762 - **DIN 912 VO**  
**Tornillo cilíndrico Allen**  
 rosca completa

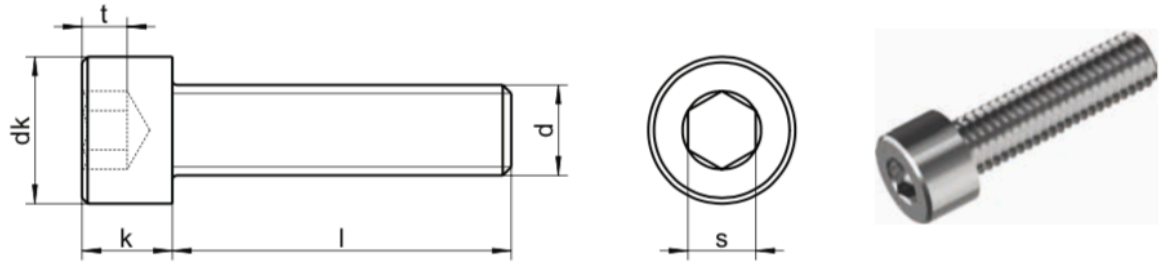

dk max.	8,5	10,0	13,0	16,0	18,0
k max.	5,0	6,0	8,0	10,0	12,0
s	4	5	6	8	10
t	2,5	3,0	4,0	5,0	6,0
●	4	5	6	8	10
<b>Long. / Ø</b>	<b>M5</b>	<b>M6</b>	<b>M8</b>	<b>M10</b>	<b>M12</b>
30	▲ ●				
35	▲ ●	▲ ●			
40	▲ ●	▲ ●	▲ ●		
45	▲ ●	▲ ●	▲ ●		
50	▲ ●	▲ ●	▲ ●	▲ ●	
60		▲ ●	▲ ●	▲ ●	▲ ●
70		▲ ●	▲ ●	▲ ●	▲ ●
80		▲ ●	▲ ●	▲ ●	▲ ●
90		▲ ●	▲ ●	▲ ●	▲ ●
100		▲ ●	▲ ●	▲ ●	▲ ●
<b>UV</b>	500	500 ≥ 45 200 ≥ 70 100	100	50	50 ≥ 70 25

■ A1 / ▲ A2 / ● A4 | UV: Unidad de venta | Todas las medidas en mm | Otras dimensiones bajo pedido  
 Ejemplo Art.-Nr.: 912-2-8X40VO DIN 912 - A2 - M8 - l = 40mm - Rosca completa